



SINCE 1963

**MODULAR
CONVEYOR SYSTEM
PRODUCT CATALOGUE
ALUMINUM**

Contents

	<u>S100</u>	Profiles and fasteners	Sid 3-26
	<u>S140</u>	Conveyor system	Sid 27-50
	<u>S200</u>	Bearing houses and pallet system	Sid 51-54
	<u>S220</u>	Conveyor system	Sid 55-71
	<u>S300</u>	Guide rails	Sid 72-89
	<u>S380</u>	Conveyor system	Sid 90-98
	<u>S400</u>	Slide rail and cover board	Sid 99-101
	<u>S620</u>	Conveyor system	Sid 102-130
	<u>S830</u>	Conveyor system	Sid 131-161
	<u>S900</u>	Drive and idler parts	Sid 162-185
	<u>S1000</u>	Drive and idler parts	Sid 186-188
	STEP-files for complete product catalogue aluminum		

 = Download STEP-files for the selected chapter

Change without notice



 STEP-files S100

S100

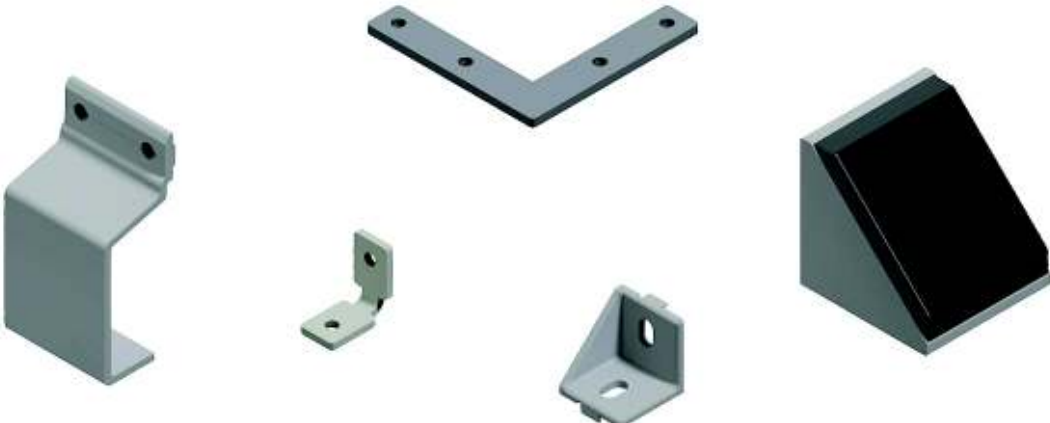

Serie 100

Profile

Anodized aluminum
Weight 1450 g/m
Length 5.8 m
Qty/package 18 pcs

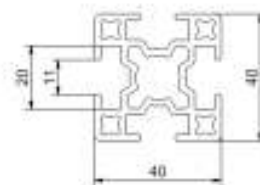

Part no. 100-1010

Profile

Anodized aluminum
Weight 2640 g/m
Length 5.8 m
Qty/package 12 pcs

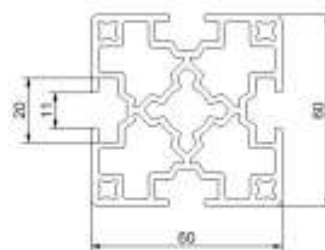

Part no. 100-1015

Profile

Anodized aluminum
Weight 1990 g/m
Length 5.8 m
Qty/package 16 pcs

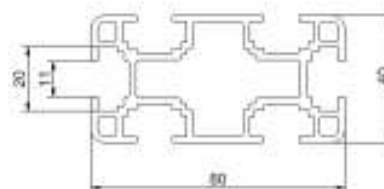

Part no. 100-1020

Profile

Anodized aluminum
Weight 3030 g/m
Length 5.8 m
Qty/package 12 pcs

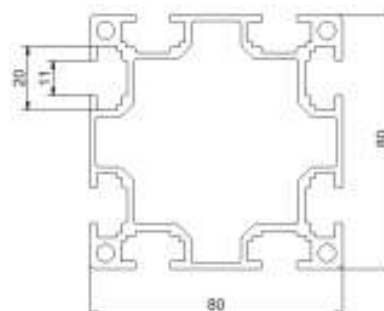

Part no. 100-1030

Serie 100

Industrial castor

Ball bearing, pivotable device castor.
Fork in galvanized steel.
Wheels in polypropylene and rubber
Weight 250 g

Part no. 100-1127

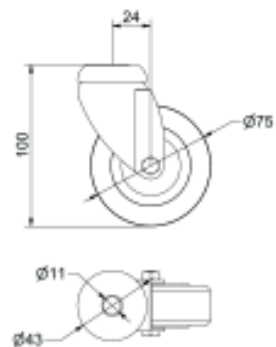

Industrial castor

With brake, ball bearing, pivotable device castor.
Fork in galvanized steel.
Wheels in polypropylene and rubber.
Weight 300 g

Part no. 100-1126

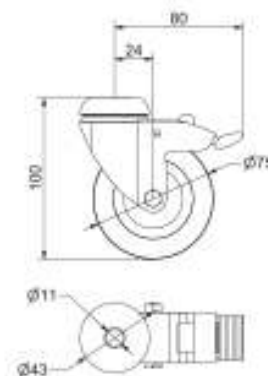

Foot

For profile 100-1030
Galvanized steel.
Weight 4160 g

Part no. 100-1131

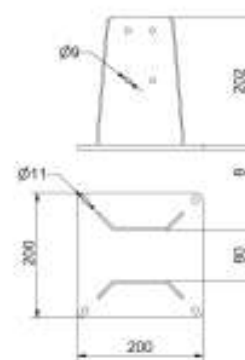

Foot

For profile 100-1015
Galvanized steel.
Weight 3440 g

Part no. 100-1141

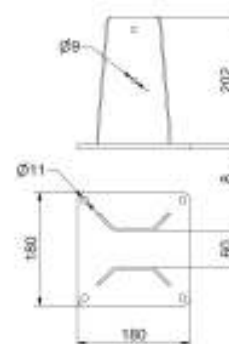

Serie 100

Foot

For profile 100-1020
Galvanized steel.
Weight 3700 g

Part no. 100-1151

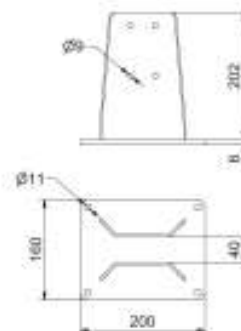

Foot

For profile 100-1010
Galvanized steel.
Weight 350 g/ pcs
Delivered in pairs (2 pcs)

Part no. 100-1152

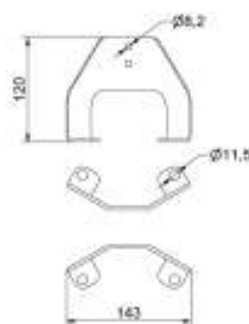

Foot

For all profiles
Galvanized steel.
Weight 2400 g/st
Delivered in pairs (2 pcs)

Part no. 100-1155

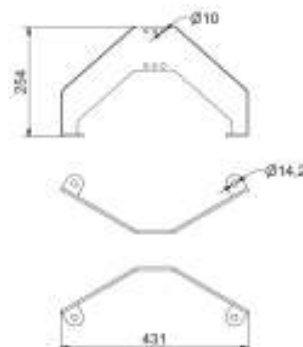

Serie 100

Adjustable foot

Galvanized steel, black nylon
Weight 45 g

Part no. 100-1110

Anti skid

Part no. 100-1111

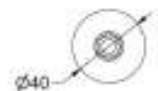

Adjustable foot

Galvanized steel, black nylon
Weight 200 g

Part no. 100-1120

Anti skid pad

Part no. 100-1121

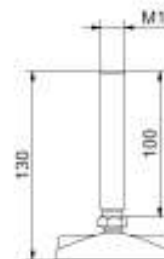

Adjustable foot

Galvanized steel
Weight 450 g

Part no. 100-1125

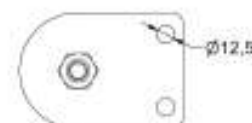
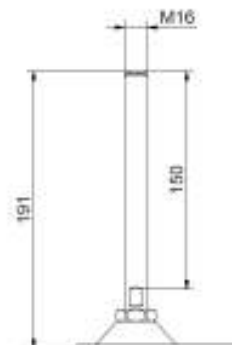

Serie 100

End plate

For profile 100-1010
Anodized aluminum
Weight 38 g

Center hole M8
Part no. 100-1165

Center hole M10
Part no. 100-1166

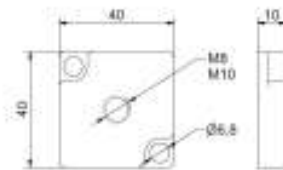

End plate

For profile 100-1015
Anodized aluminum
Weight 75 g

Center hole M8
Part no. 100-1167

Center hole M10
Part no. 100-1168

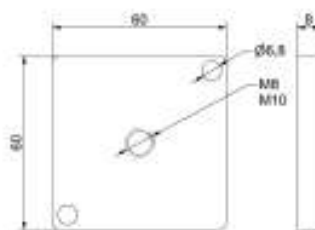

End plate

For profile 100-1020
Anodized aluminum
Weight 66 g

Center hole M8
Part no. 100-1182

Center hole M10
Part no. 100-1181

Center hole M16
Part no. 100-1180

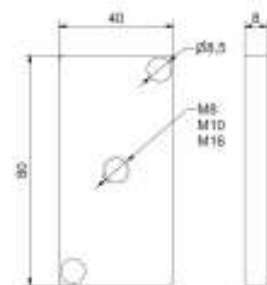

End plate

For profile 100-1030
Anodized aluminum
Weight 14 g

Center hole M8
Part no. 100-1171

Center hole M10
Part no. 100-1172

Center hole M16
Part no. 100-1170

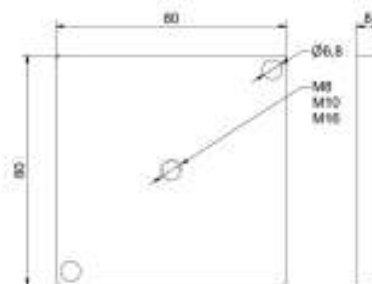

Serie 100

Support bracket

For conveyor profile 380-1000
 Anodized aluminum
 Weight 70 g

Part no. 100-1200

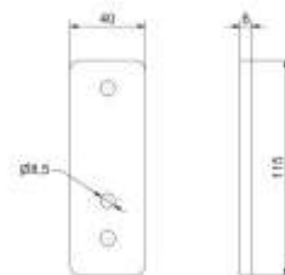

Support bracket

For conveyor profile 620-1000
 Anodized aluminum
 Weight 123 g

Part no. 100-1225

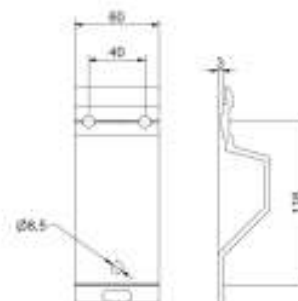

Support bracket

For conveyor profile 830-1000 and
 140-1000
 Anodized aluminum
 Weight 175 g

Part no. 100-1230

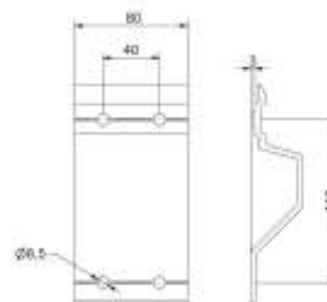

Support bracket

Intended to be used with drip tray
 For conveyor profile 620-1000
 Anodized aluminum
 Weight 206 g

Part no. 100-1270

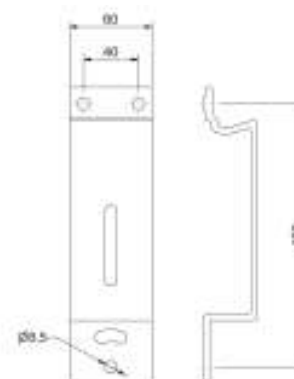

Serie 100

Support bracket

For all conveyor profiles
Anodized aluminum
Weight 75 g

Part no. 100-1220

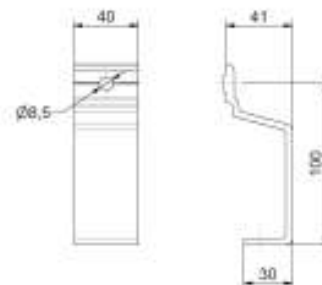

Support bracket

For all conveyor profiles
Anodized aluminum
Weight 110 g

Part no. 100-1235

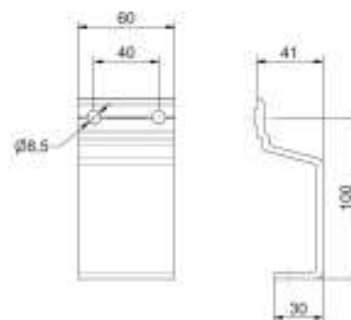

Support bracket

For all conveyor profiles
Anodized aluminum
Weight 150 g

Part no. 100-1240

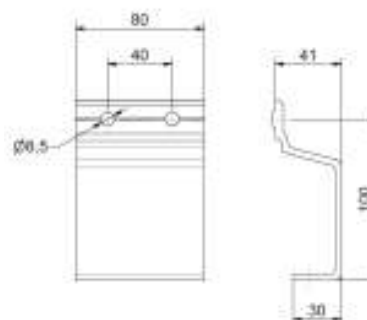

Serie 100

Support stand

For S620
Anodized aluminum

Part no. 100-1351

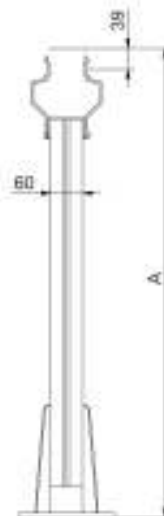

Support stand

For S830 and S140
Anodized aluminum

Part no. 100-1341

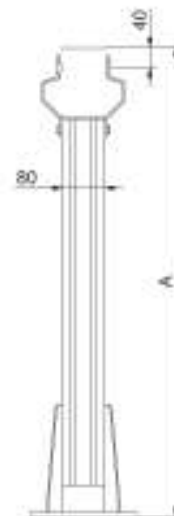

Support stand

For S220
Anodized aluminum

Part no. 100-1346

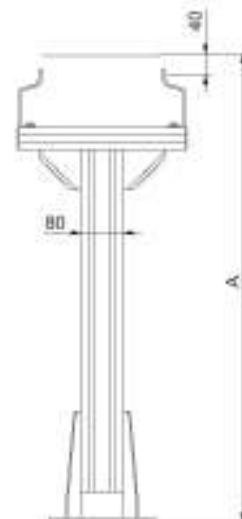

Serie 100

Support stand

For S380
Anodized aluminum

Part no. 100-1365

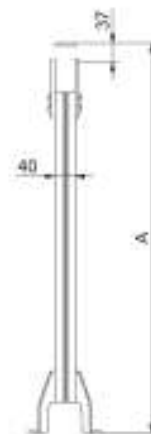

Support stand

For S620
Anodized aluminum

Part no. 100-1380

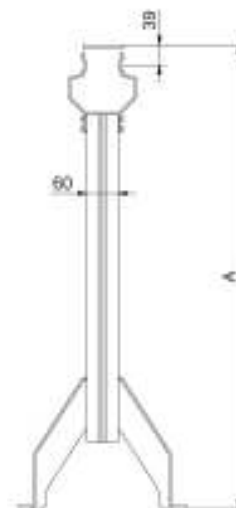

Support stand

For S830 and S140
Anodized aluminum

Part no. 100-1370

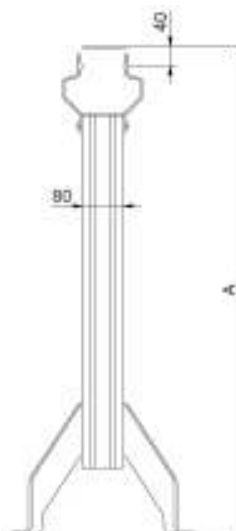

Serie 100

Support stand

For S220
Anodized aluminum

Part no. 100-1375

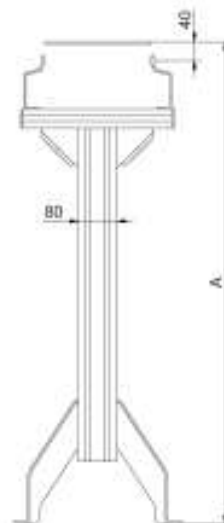

Serie 100

Width adjustment actuator

Width adjustment actuator for side grip conveyor
Stainless steel

Part no.	Width
100-1400-0-100	0-100 mm
100-1400-0-150	0-150 mm
100-1400-0-200	0-200 mm
100-1400-0-250	0-250 mm
100-1400-0-300	0-300 mm

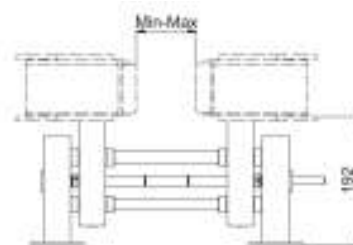

Enter width when ordering.
Other widths on request.

Sprocket

Sprocket for width adjustment actuator
21 teeth, white acetal

Part no. 100-1420

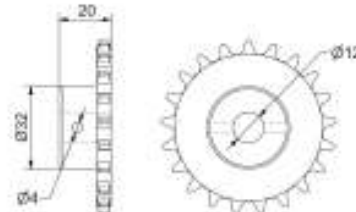

Chain

Chain 3/8 " for width adjustment actuator
Nickel-plated steel chain

Enter length when ordering.
Complete with chain lock.



Part no. 100-1430

Chain lock

Part no. 100-1432

Semi-link

Part no. 100-1434

Serie 100

End cap

For profile 100-1010
Black polypropylene
Weight 8 g

Part no. 100-2010

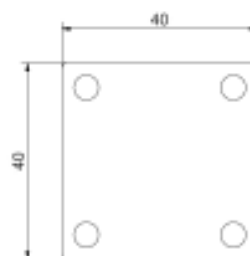

End cap

For profile 100-1010
Black acetal
Weight 8 g

Part no. 100-2015



End cap

End cap with steering heel
for profile 100-1010
Black acetal
Weight 9 g

Part no. 100-2016

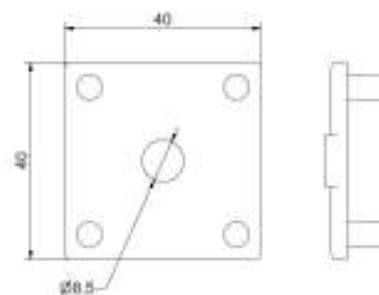

End cap

End cap with steering heel for profile
100-1010 for S140
Black acetal
Weight 10 g

Part no. 100-2017

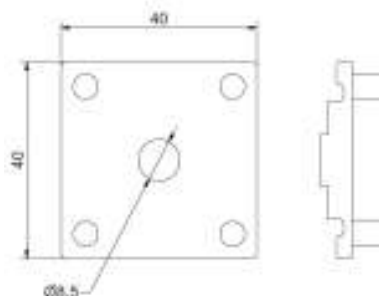

Serie 100

End cap

For profile 100-1015
Black polypropylene
Weight 17 g

Part no. 100-2040

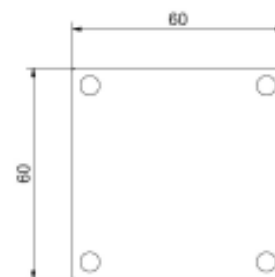

End cap

For profile 100-1020
Black polypropylene
Weight 19 g

Part no. 100-2020

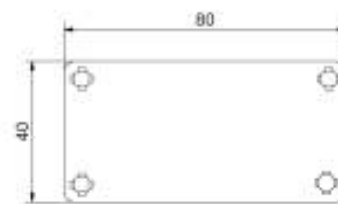

End cap

For profile 100-1030
Black polypropylene
Weight 39 g

Part no. 100-2030

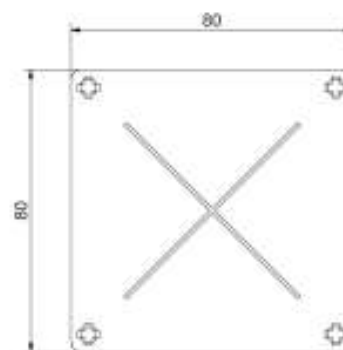
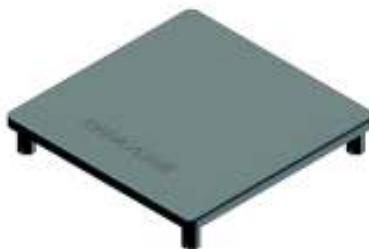

Serie 100

Angle bracket

Angle bracket 45° for profile 40x80,
60x60 and 80x80
Zinc die-cast
Supplied with stop screw M8x16
Weight 205 g

Part no. 100-3010

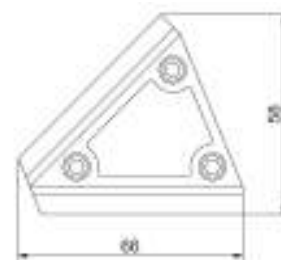
**Angle bracket**

Angle bracket 135° for profile 40x80,
60x60 and 80x80
Zinc die-cast
Supplied with stop screw M8x16
Weight 210 g

Part no. 100-3020

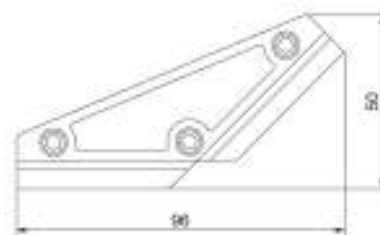

Serie 100

Angle bracket

Angle bracket 45° for profile 40x40,
40x80 and 80x80
Zinc die-cast
Supplied with screw M8x35
Weight 232 g

Part no. 100-3025

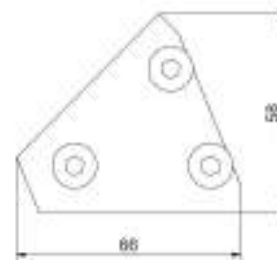
**Angle bracket**

Angle bracket 90° for profile 40x40,
40x80 och 80x80
Zinc die-cast
Supplied with screw M8x35
Weight 240 g

Part no. 100-3035

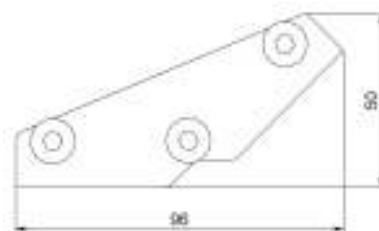

Serie 100

Bracket

Bracket for profile 40x40 and 40x80
Zinc die-cast
Weight 48 g

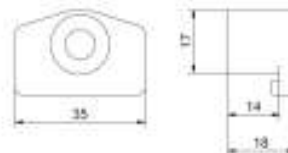

Part no. 100-4010

Angle bracket

Angle bracket 90° for profile 40x40,
40x80, 60x60 and 80x80
Zinc die-cast
Weight 88 g

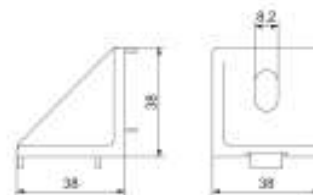

Part no. 100-4020

Angle bracket

Angle bracket 90° for profile 60x60
Zinc die-cast
Weight 110 g



Part no. 100-4030

Angle bracket

Angle bracket 90° for beam 80x80
Zinc die-cast
Weight 225 g



Part no. 100-4040

Serie 100

Cover cap

For angle bracket 100-4030
 Black polypropylen
 Weight 16 g

Part no. 100-4130

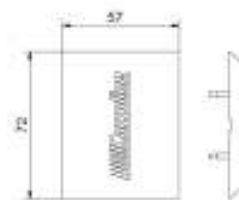

Cover cap

For angle bracket 100-4040
 Black polypropylen
 Weight 29 g

Part no. 100-4140

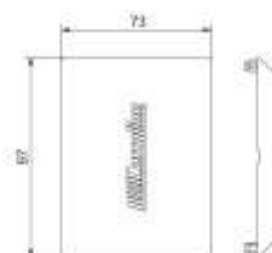
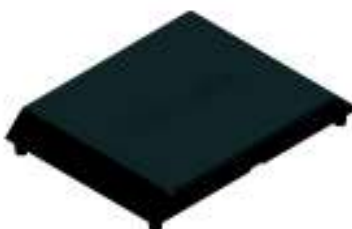

Angle bracket

Angle bracket 100-4030 with cover cap
 100-4130
 Weight 125 g

Part no. 100-4230

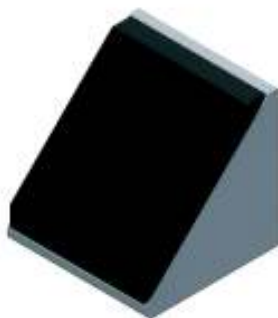

Angle bracket

Angle bracket 100-4040 with cover cap
 100-4140
 Weight 255 g

Part no. 100-4240

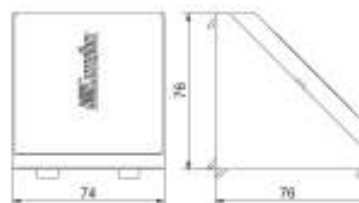
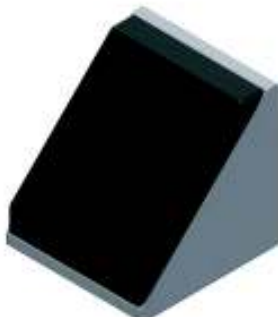

Serie 100

Connecting plate T-cross

For profile 40x40 and 40x80
Galvanized steel
Weight 300 g

Part no. 100-5010

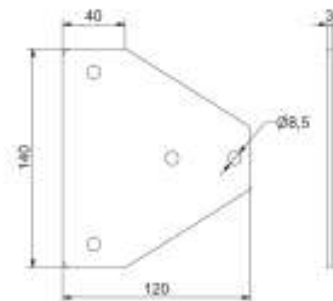

Connecting plate

Connecting plate 45° for profile 40x40
and 40x80
Galvanized steel
Weight 277 g

Part no. 100-5015

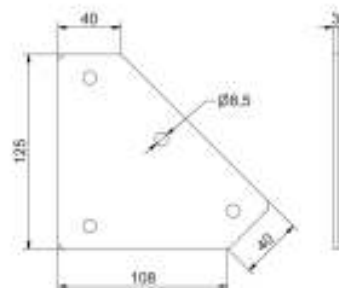

Connecting plate

Connecting plate 90° for profile 40x40
and 40x80
Galvanized steel
Weight 257 g

Part no. 100-5020

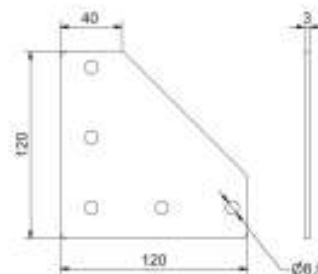

Serie 100

Connecting plate T-cross

For profile 40x80 and 80x80
Galvanized steel
Weight 660 g

Part no. 100-5025

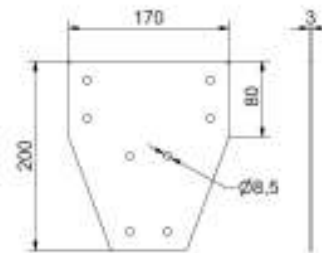

Connecting plate

Connecting plate 45° for profile 40x80
and 80x80
Galvanized steel
Weight 760 g

Part no. 100-5030

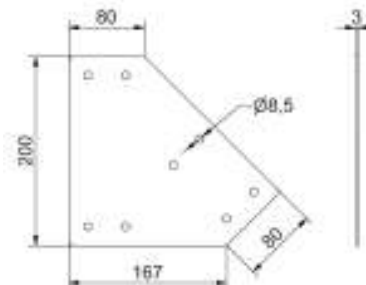

Connecting plate

Connecting plate 90° for profile 40x80
and 80x80
Galvanized steel
Weight 760 g

Part no. 100-5035

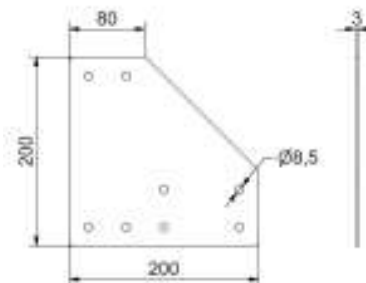
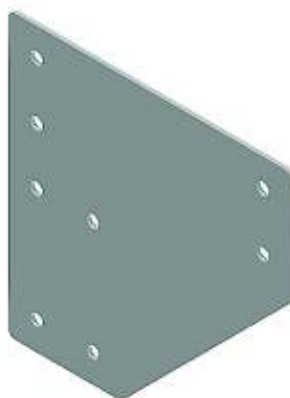

Serie 100

Square nut

Galvanized steel, weight 14 g
50 Pcs/box

Part no.	D = Thread
100-6000	M4
100-6010	M5
100-6020	M6
100-6030	M8
<i>Stainless Steel</i> 500-4370	M6
<i>Stainless Steel</i> 500-4380	M8

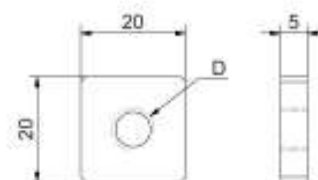

Slot nut

Galvanized steel
Weight 8 g

Slot nut D= M6
Part no. 100-6040

Slot nut D= M8
Part no. 100-6045

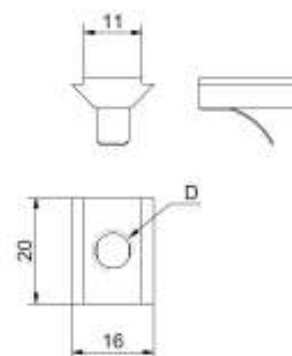

T-bolt

T-bolt M8, galvanized steel
Weight 15-36 g
50 Pcs/box

Part no.	L = Length
100-6060	17 mm
100-6070	24 mm
100-6080	35 mm
100-6090	53 mm
100-6095	71 mm
100-6098	85 mm
<i>Stainless Steel</i> 500-4400	17 mm

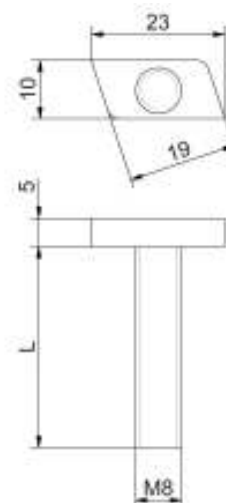

Serie 100

Connecting strip

Galvanized steel
Weight 110 g

Part no. 100-7010

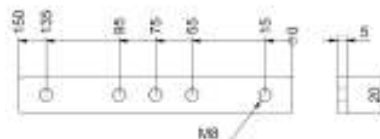

Connecting strip

Stainless steel
Weight 115 g

Part no. 100-7011

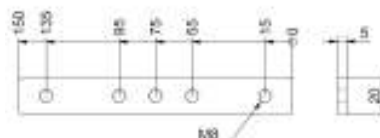

Connecting strip

Galvanized steel
Weight 66 g

Part no. 100-7015

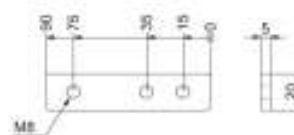

Connecting strip

Connecting strip 90°
Galvanized steel
Weight 115 g

Part no. 100-7020

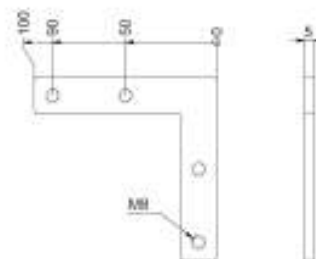

Serie 100

Connecting strip

Connecting strip 90°
Galvanized steel
Weight 73 g

Part no. 100-7022

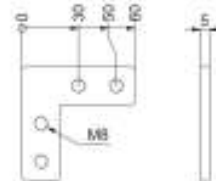

Connecting strip

Connecting strip 45°
Galvanized steel
Weight 98 g

Part no. 100-7025

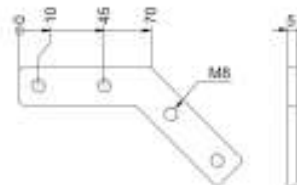

Connecting strip

Connecting strip for vertical bend R400
Galvanized steel
Weight 110 g

Part no. 100-7026

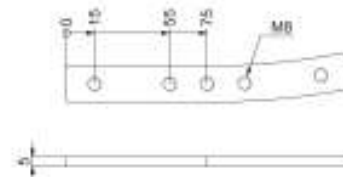

Connecting strip

Connecting strip for vertical bend R860
Galvanized steel
Weight 110 g

Part no. 100-7027

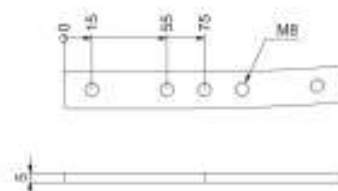

Serie 100

Connecting strip

Connecting strip for vertical bend R860
Galvanized steel
Weight 80 g

Part no. 100-7028

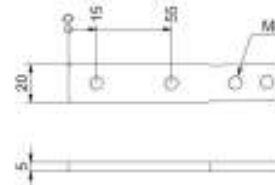
**Connecting strip**

Connecting strip 90°
Galvanized steel
Weight 35 g

Part no. 100-7029

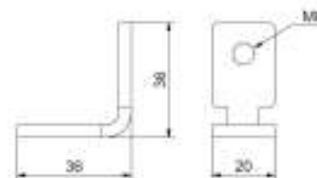
**Stop screw**

Used for all types of connecting strips
Galvanized steel
Weight 4 g

Part no. 100-7030

