 STEP-files S900

S900



Serie 900

Sprocket

Sprocket for S830, S140 and S220
 Black reinforced nylon and galvanized steel
 Weight 131 g

Part no. 900-1010

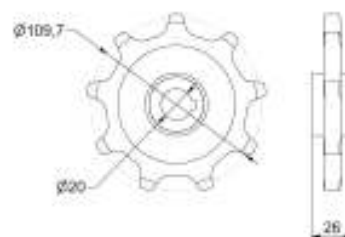

Sprocket

Sprocket for S620
 Black reinforced nylon and galvanized steel
 Weight 118 g

Part no. 900-1020

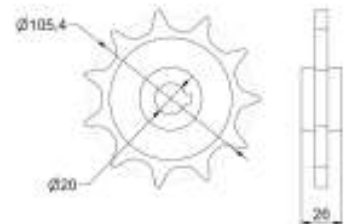

Sprocket

Sprocket for S380
 Black acetal
 Weight 35 g

Part no. 900-1025

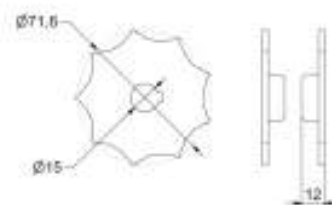

Sprocket

Sprocket for chain 620-2200
 Green amide plastic and galvanized steel
 Weight 70 g

Part no. 900-1026

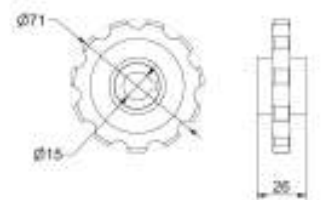

Serie 900

Sprocket

Sprocket for 1/2" chain and shaft \varnothing 20 mm
 19 teeth
 Untreated steel
 Weight 630 g

Part no. 16656

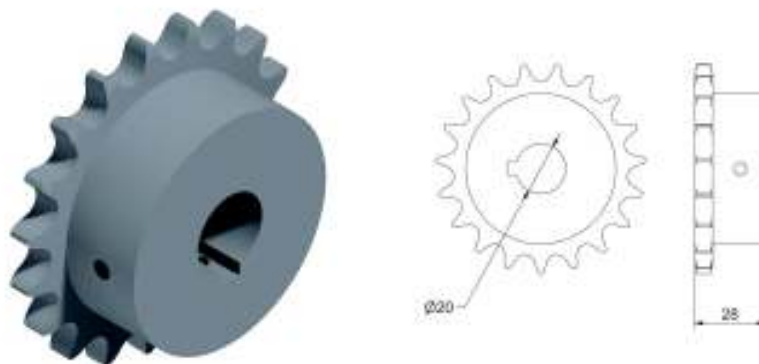

Sprocket

Sprocket for 1/2" chain and clamping joint
 19 teeth
 Untreated steel
 Weight 330 g

Part no. 16657



Chain

Chain 1/2" for suspended drive, intermediate, and catenary drive unit.
 Delivered in number of links/semi-link including chain lock.
 Untreated steel.

Part no.	Nr of links
16840	19 links including chain lock
16843	19 links + semi-link including chain lock
17048	34 links including chain lock



Serie 900

Timing pulley

Timing pulley AT10 with flanges
24 teeth
Aluminum
Weight 240 g

Part no. 17047

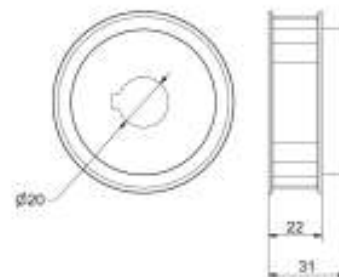
**Timing belt**

Timing belt AT10 with length 890 mm
and width 16 mm.
Polyurethane
Weight 85 g

Part no. 17046



Serie 900

Idler wheel

Idler wheel with ball bearings 6202-2Z
for S620, S830 and S140
Black reinforced nylon
Weight 175 g

Part no. 900-1035

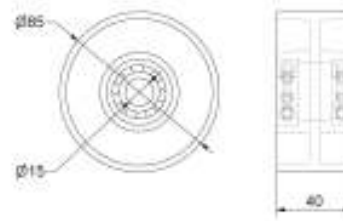

Idler wheel

Idler wheel with ball bearings 6003-2Z
for S220
Black reinforced nylon
Weight 163 g

Part no. 900-1037

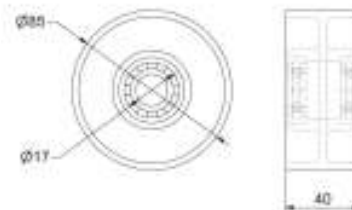

Idler wheel

Idler wheel with ball bearings 6003-2Z
for S220
White acetal
Weight 160 g

Part no. 900-1036

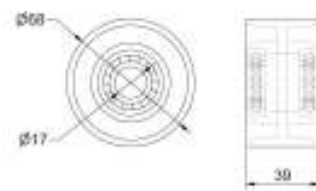

Idler wheel

Idler wheel with ball bearings 6202-2Z
for idler unit 830-4010R/L
White acetal
Weight 160 g

Part no. 900-1030

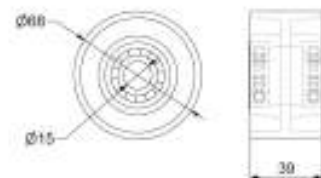

Serie 900

Idler wheel

Idler wheel for S380
 Black acetal
 Weight 38 g

Part no. 900-1038



Idler wheel

Idler wheel with ball bearings 6202-2Z
 for chain 620-2200
 Green amide plastic
 Weight 90 g

Part no. 900-1032

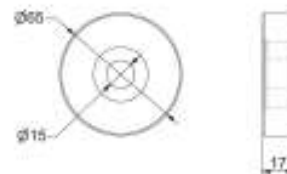

Shaft for idler

Shaft for idler units according to table
 Stainless steel

Part no.	Idler unit
13800	620-4005 620-4055
13382	830-4005 830-4055
13801	140-4005 140-4055
13802	220-4005



Serie 900

Shaft for drive unit

Shaft for SEW WA 20 and Lenze B45 for drive units according to table.
Stainless steel

SEW WA30, SA37 and Lenze B110 uses drive shaft along with correct spacer according to table.



Standard drive shafts for SEW WA20 and Lenze B45			Part. No for spacers for other gears including M6 x 35	
Drive shaft Part.no	Fits drive unit	Length of drive shaft	Spacer for WA30 and B110	Spacer for SA37
13146	620-30	191 mm	15261	15262
13262	620-31/830-31 140-31/220-31	134 mm	15261	15262
13271	620-31	128 mm		
13176	620-32	238 mm	15261	15262
13160	620-32/620-33	118 mm		
13185	620-33	239 mm	15261	15262
13144	830-30/830-34	213 mm	15261	15262
13270	830-31	143 mm		
13177	830-32	260 mm	15261	15262
13161	830-32/830-33 140-32/140-33	138 mm		
13186	830-33/140-33	261 mm	15261	15262
13143	140-30	273 mm	15261	15262
13269	140-31	203 mm		
13178	140-32	290 mm	15261	15262
13142	220-30	351 mm	15261	15262
13268	220-31	281 mm		
16852	220-32	402 mm	15261	15262
16854	220-32	275 mm		

Serie 900

Chain guide

Chain guide for drive unit S620 and S830
 Black reinforced nylon
 Weight 34 g
 Manufactured in version right and left.
 R = Right
 L = Left

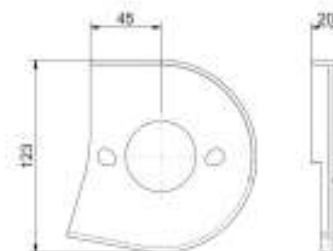

Part no. 900-2120R
Part no. 900-2120L

Chain guide

Chain guide for drive unit S140 and S220
 Black reinforced nylon
 Weight 45 g
 Manufactured in version right and left.
 R = Right
 L = Left

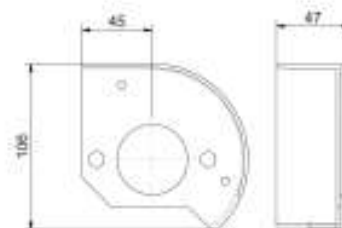

Part no. 900-2100R
Part no. 900-2100L

Chain guide

Chain guide for idler unit S620 and S830
 Black reinforced nylon
 Weight 27 g
 Manufactured in version right and left.
 R = Right
 L = Left

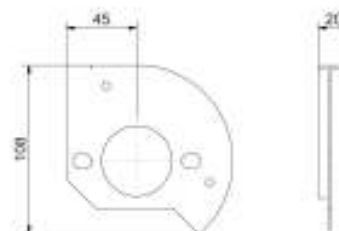

Part no. 900-2121R
Part no. 900-2121L

Chain guide

Chain guide for idler unit S140
 Black reinforced nylon
 Weight 44 g
 Manufactured in version right and left.
 R = Right
 L = Left

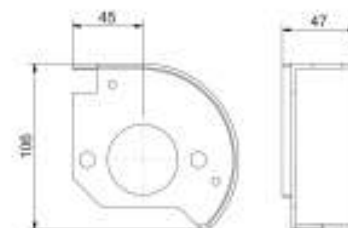

Part no. 900-2110R
Part no. 900-2110L

Serie 900

Chain guide

Chain guide for idler unit S220
 Black reinforced nylon
 Weight 45 g

Manufactured in version right and left.
 R = Right
 L = Left

Part no. 900-2115R
Part no. 900-2115L

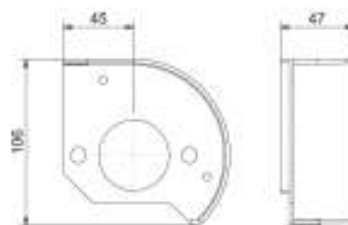

Chain guide

Chain guide for idler unit S380
 Black acetal
 Weight 15 g

Part no. 900-2125

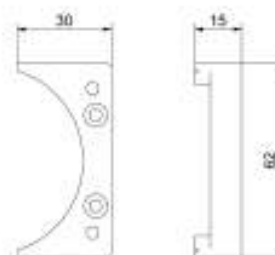

Chain guide

Chain guide for idler unit S380
 Black acetal
 Weight 24 g

Manufactured in version right and left.
 R = Right
 L = Left

Part no. 900-2127R
Part no. 900-2127L

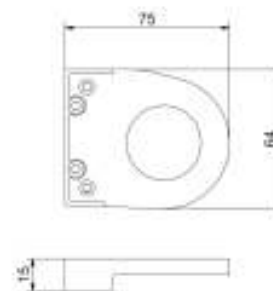

Slide rail

Slide rail for intermediate drive unit
 S140
 White nylon
 Weight 130 g

Part no. 900-2135

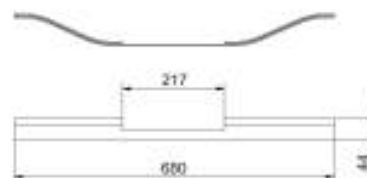

Serie 900

Return guide

Return guide for chain
 Black acetal
 Weight 7 g

Part no. 900-2140

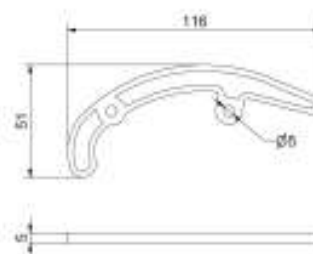

Return guide

Return guide for chain, with
 countersunk holes
 Black acetal
 Weight 7 g

Manufactured in version right and left.
 R = Right
 L = Left

Part no. 900-2150R

Part no. 900-2150L

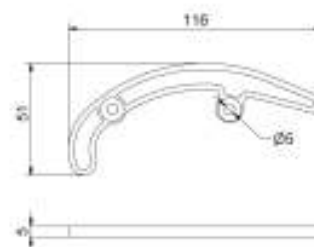

Return guide

Return guide for chain, with
 countersunk holes and milled edges.
 Black acetal
 Weight 7 g

Manufactured in version right and left.
 R = Right
 L = Left

Part no. 900-2160R

Part no. 900-2160L

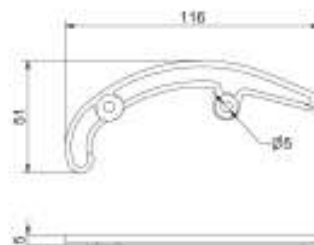

Serie 900

Slide bar

Slide bar for intermediate drive unit
S620, S830 and S140
Galvanized steel
Weight 260 g

Part no. 900-2136



Slide bar

Slide bar for intermediate drive unit
S220
Galvanized steel
Weight 260 g

Manufactured in version right and left.
R = Right
L = Left

Part no. 15305R
Part no. 15305L



Gas spring

Gas spring including eye end fitting
Weight 95 g

Part no.	Spring force
900-2231	40 N
900-2232	80 N
900-2230	120 N
900-2233	200 N
900-2234	280 N
900-2235	350 N



Serie 900

Chain guard

Chain guard for chain transmission
 Black thermoplastic
 Weight 245 g

Part no. 900-2260

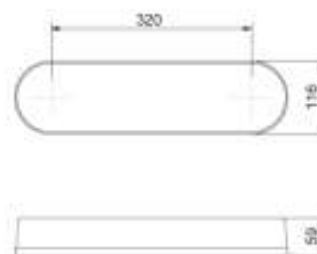

Chain guard

Chain guard for chain transmission
 Black thermoplastic
 Weight 120 g

Part no. 900-2270

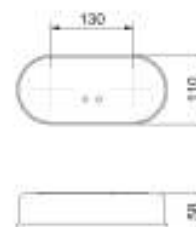

Cover

Cover for drive unit and idler unit for
 S380
 Black reinforced nylon
 Weight 14 g

Manufactured in version right and left.
 R = Right
 L = Left

Part no. 900-2280R

Part no. 900-2280L



Serie 900

Mounting plate

Mounting plate standard.
Anodized aluminum
Weight 142 g

Part no. 900-3077

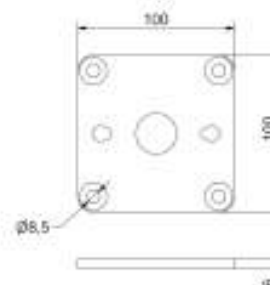

Mounting plate

Mounting plate with bracket for roller transfer
Anodized aluminum
Weight 157 g

Part no. 900-3117

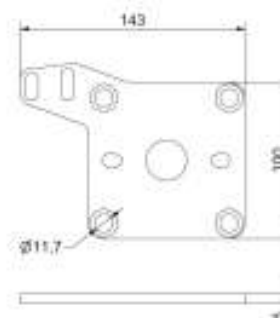

Mounting plate

Mounting plate with connecting strip and bracket for roller transfer
Anodized aluminum
Weight 335 g

Part no. 900-3119

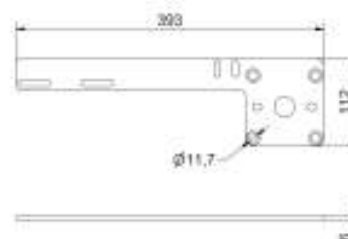

Mounting plate

Mounting plate with connecting strip, bracket for roller transfer and 7mm level difference
Anodized aluminum
Weight 340 g

Part no. 900-3118

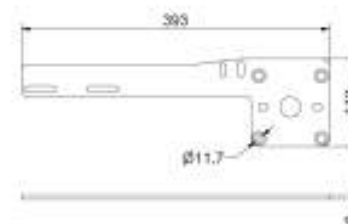

Serie 900

Motor plate

Motor plate for SEW WA20, WA30,
SA37 and Lenze B45
Anodized aluminum
Weight 130 g

Part no. 900-3075

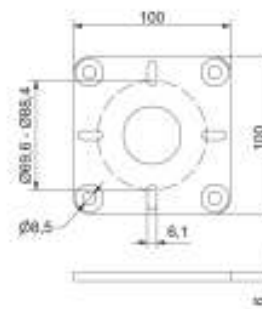

Motor plate

Motor plate for Lenze B110
Anodized aluminum
Weight 130 g

Part no. 900-3076

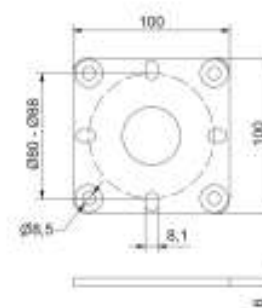

Bracket

Bracket for idler unit with roller transfer
Anodized aluminum
Weight 90 g

Part no. 900-7111

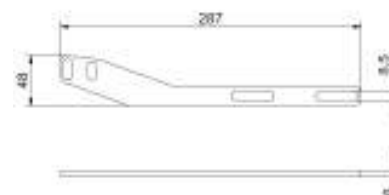

Bracket

Bracket for drive unit with roller transfer
Anodized aluminum
Weight 90 g

Part no. 900-7112

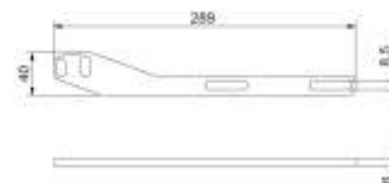

Serie 900

Connecting strip

Connecting strip between conveyors
Anodized aluminum
Weight 325 g

Part no. 900-7120

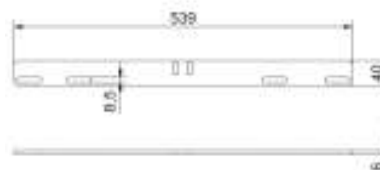

Connecting strip

Connecting strip between conveyors
with 7mm level difference
Anodized aluminum
Weight 330 g

Part no. 900-7130

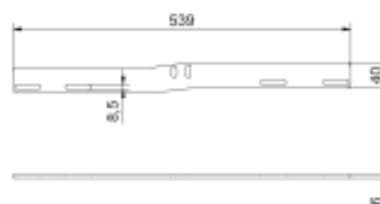

Conveyor bracket

Conveyor bracket for drive unit
Galvanized steel
Weight 295 g

Part no. 900-3200

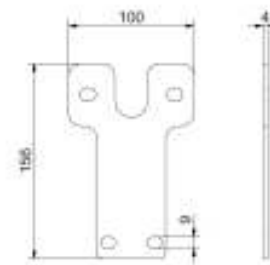

Serie 900

Roller transfer

Roller transfer for S620
Reinforced nylon, acetal, anodized aluminum, stainless and galvanized steel
Weight 157 g

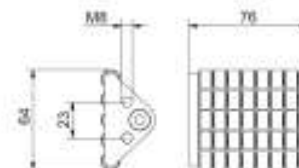

Art.nr 900-7000

Roller transfer

Roller transfer for S830
Reinforced nylon, acetal, anodized aluminum, stainless and galvanized steel
Weight 195 g

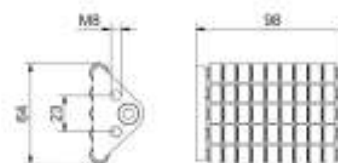

Part no. 900-7010

Roller transfer

Roller transfer for S140
Reinforced nylon, acetal, anodized aluminum, stainless and galvanized steel
Weight 305 g

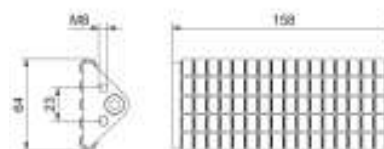

Part no. 900-7020

Roller transfer

Roller transfer for S220
Reinforced nylon, acetal, anodized aluminum, stainless and galvanized steel
Weight 443 g

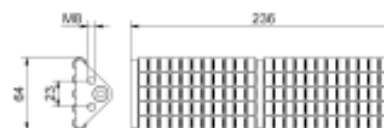

Part no. 900-7030

Serie 900

SEW WA20 with motor

SEW WA20 with motor.
 Enter output rpm according to table
 when ordering.
 Other add-on on request
 Weight 7000-8800 g

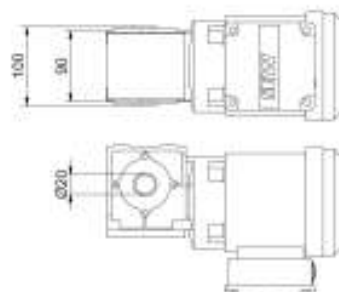

Order example

900-4025/53 ← Rpm

Part no. for WA20	Power	Rpm	Speed at 50 Hz m/min	Ratio
900-4025	0,25 kW	22	8	60
900-4025	0,25 kW	27	10	48
900-4025	0,25 kW	33	12	39
900-4025	0,25 kW	40	14	32,5
900-4025	0,25 kW	47	16	27,5
900-4025	0,25 kW	53	18	24,5
900-4025	0,25 kW	67	23	19,5
900-4025	0,25 kW	79	27	16,5
900-4025	0,25 kW	91	32	14,33
900-4025	0,25 kW	127	44	10,25
900-4025	0,25 kW	159	55	8,2
Part no. for WA20	Power	RPM	Speed at 50 Hz m/min	Ratio
900-4030	0,37 kW	50	17	27,5
900-4030	0,37 kW	56	19	24,5
900-4030	0,37 kW	71	24	19,5
900-4030	0,37 kW	84	29	16,5
900-4030	0,37 kW	96	33	14,33
900-4030	0,37 kW	135	46	10,25
900-4030	0,37 kW	168	57	8,2

Serie 900

SEW WA30 with motor

SEW WA30 with motor.
 Enter output rpm according to table
 when ordering.
 Other add-on on request
 Weight 11000-13000 g

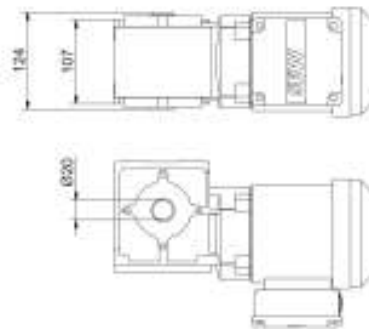

Order example

900-4040/56 ← **Rpm**

Part no. for WA30	Power	Rpm	Speed at 50 Hz m/min	Ratio
900-4040	0,37 kW	18	6	75
900-4040	0,37 kW	23	8	60
900-4040	0,37 kW	29	10	48
900-4040	0,37 kW	35	12	39
900-4040	0,37 kW	42	15	32,5
900-4040	0,37 kW	50	17	27,5
900-4040	0,37 kW	56	19	24,5
900-4040	0,37 kW	71	24	19,5
900-4040	0,37 kW	84	29	16,33
900-4040	0,37 kW	96	33	14,33
900-4040	0,37 kW	135	46	10,25
900-4040	0,37 kW	168	56	8,2
Part no. for WA30	Power	Rpm	Speed at 50 Hz m/min	Ratio
900-4045	0,55 kW	42	17	32,5
900-4045	0,55 kW	50	19	27,5
900-4045	0,55 kW	56	24	24,5
900-4045	0,55 kW	84	29	16,33
900-4045	0,55 kW	96	33	14,33
900-4045	0,55 kW	135	46	10,25
900-4045	0,55 kW	168	57	8,2

Serie 900

SEW SA37 with motor

SEW SA37 with motor.
 Enter output rpm according to table
 when ordering.
 Other add-on on request
 Weight 13000 g

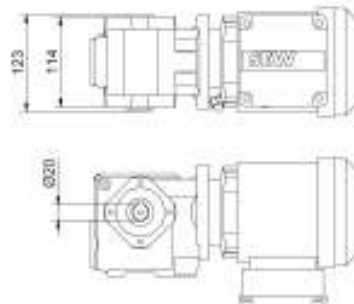

Order example

Rpm

900-4050/54

Part no. for SA37	Power	Rpm	Speed at 50 Hz m/min	Ratio
900-4050	0,37 kW	22	8	63,33
900-4050	0,37 kW	27	10	51,3
900-4050	0,37 kW	37	13	37,66
900-4050	0,37 kW	45	16	30,68
900-4050	0,37 kW	54	19	25,38
900-4050	0,37 kW	69	24	19,89
900-4050	0,37 kW	76	27	18,24
900-4050	0,37 kW	89	31	15,53
900-4050	0,37 kW	103	36	13,39

Serie 900

Lenze B45 with motor

Lenze G500-B45 with motor.
 Enter output rpm according to table
 when ordering.
 Other add-on on request
 Weight 7000-9300 g

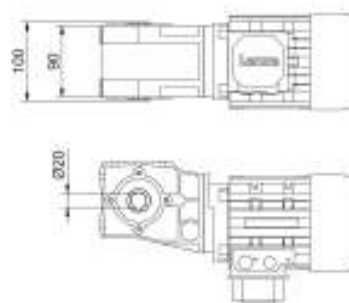

Order example

Rpm → **900-4210/55**

Part no. for G500-B45	Power	Rpm	Speed at 50 Hz m/min	Ratio
900-4210	0,18 kW	36	13	37,48
900-4210	0,18 kW	42	15	32,59
900-4210	0,18 kW	47	17	28,8
900-4210	0,18 kW	55	19	25,05
900-4210	0,18 kW	61	21	22,27
900-4210	0,18 kW	71	25	19,36
900-4210	0,18 kW	79	28	17,37
900-4210	0,18 kW	90	31	15,11
900-4210	0,18 kW	102	36	13,38
900-4210	0,18 kW	117	41	11,64
900-4210	0,18 kW	130	45	10,46
Part no. for G500-B45	Power	Rpm	Speed at 50 Hz m/min	Ratio
900-4211	0,25 kW	55	19	25,05
900-4211	0,25 kW	62	22	22,27
900-4211	0,25 kW	71	25	19,36
900-4211	0,25 kW	79	28	17,37
900-4211	0,25 kW	91	32	15,11
900-4211	0,25 kW	102	36	13,38
900-4211	0,25 kW	118	41	11,64
900-4211	0,25 kW	131	46	10,46
More options				→

Serie 900

Cont. Lenze G500-B45 with motor

Part no. for G500-B45	Power	Rpm	Speed at 50 Hz m/min	Ratio
900-4212	0,37 kW	81	28	17,37
900-4212	0,37 kW	93	32	15,11
900-4212	0,37 kW	105	36	13,38
900-4212	0,37 kW	121	42	11,64
900-4212	0,37 kW	135	47	10,46
900-4212	0,37 kW	155	54	9,1
Part no. for G500-B45	Power	Rpm	Speed at 50 Hz m/min	Ratio
900-4213	0,55 kW	73	26	19,36
900-4213	0,55 kW	81	28	17,37
900-4213	0,55 kW	93	32	15,11
900-4213	0,55 kW	105	37	13,38
900-4213	0,55 kW	121	42	11,64
900-4213	0,55 kW	135	46	10,46

Lenze B45 with Smart motor

Lenze G500-B45 with Smart motor and 0,47 kW.
Configurable with NFC for variable speeds
Weight 8800 g

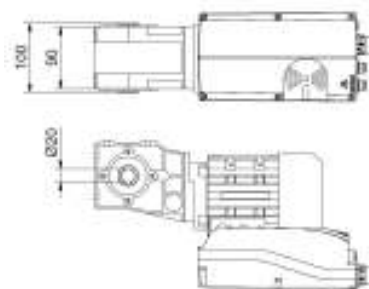

Part no. for G500-B45 Smart motor	Power	Rpm	Speed at 50 Hz m/min	Ratio
900-4214	0,47 kW	17-90	6-31	28,08
900-4215	0,47 kW	29-150	10-50	17,37

Serie 900

Lenze B110 with motor

Lenze G500-B110 with motor.
 Enter output rpm according to table
 when ordering.
 Other add-on on request
 Weight 8600-10000 g

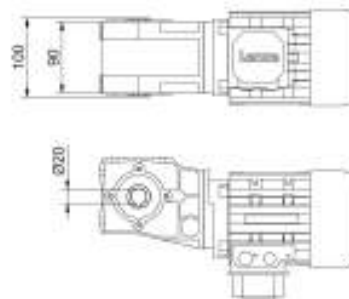

Order example

900-4216/54 ← Rpm

Part no. for G500-B110	Power	Rpm	Speed at 50 Hz m/min	Ratio
900-4216	0,18 kW	26	8	52,69
900-4216	0,18 kW	28	10	48,16
900-4216	0,18 kW	34	12	40
900-4216	0,18 kW	43	15	31,91
900-4216	0,18 kW	54	19	25,18
900-4216	0,18 kW	61	21	22,48
900-4216	0,18 kW	70	25	19,55
900-4216	0,18 kW	94	33	14,6
900-4216	0,18 kW	108	38	12,69
900-4216	0,18 kW	119	41	11,44
Part no. for G500-B110	Power	Rpm	Speed at 50 Hz m/min	Ratio
900-4217	0,25 kW	30	11	46
900-4217	0,25 kW	34	12	40
900-4217	0,25 kW	43	15	31,91
900-4217	0,25 kW	54	19	25,18
900-4217	0,25 kW	61	21	22,48
900-4217	0,25 kW	70	25	19,55
900-4217	0,25 kW	77	27	17,88
900-4217	0,25 kW	88	31	15,55
900-4217	0,25 kW	108	38	12,69
More options				→

Serie 900

Cont. Lenze G500-B110 with motor

Order example

900-4218/56

Rpm

Part no. for G500-B110	Power	Rpm	Speed at 50 Hz m/min	Ratio
900-4217	0,25 kW	120	42	11,44
900-4217	0,25 kW	131	46	10,46
900-4217	0,25 kW	151	52	9,10
Part no. for G500-B110	Power	Rpm	Speed at 50 Hz m/min	Ratio
900-4218	0,37 kW	31	11	46
900-4218	0,37 kW	38	13	10,46
900-4218	0,37 kW	44	16	31,91
900-4218	0,37 kW	56	20	25,18
900-4218	0,37 kW	63	22	22,48
900-4218	0,37 kW	72	25	19,55
900-4218	0,37 kW	79	28	17,88
900-4218	0,37 kW	91	32	15,55
900-4218	0,37 kW	97	34	14,60
900-4218	0,37 kW	111	39	12,69
900-4218	0,37 kW	123	43	11,44
900-4218	0,37 kW	135	47	10,46
Part no. for G500-B110	Power	Rpm	Speed at 50 Hz m/min	Ratio
900-4219	0,55 kW	49	17	28,96
900-4219	0,55 kW	56	20	25,18
900-4219	0,55 kW	63	22	22,48
900-4219	0,55 kW	72	25	19,55
900-4219	0,55 kW	79	28	17,88
900-4219	0,55 kW	90	31	15,55
900-4219	0,55 kW	111	39	12,69
900-4219	0,55 kW	123	43	11,44
900-4219	0,55 kW	134	47	10,46

Serie 900

Lenze SSN31 with motor

Lenze SSN31 with motor.
 Enter output rpm according to table
 when ordering.
 Other add-on on request
 Weight 4500 g

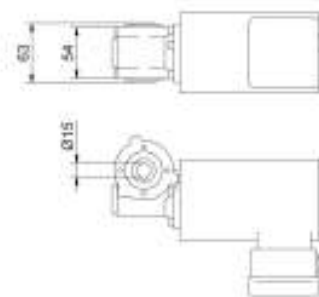

Order example

Rpm

900-4200/54

Part no. for SSN31	Power	Rpm	Speed at 50 Hz m/min	Ratio
900-4200	0,06 kW	5	62	7,84
900-4200	0,06 kW	7	44	5,74
900-4200	0,06 kW	10	31	4,33
900-4200	0,06 kW	15	21	3,43
900-4200	0,06 kW	20	16	2,59
900-4200	0,06 kW	25	12	2,19
900-4200	0,06 kW	30	10	2,02
900-4200	0,06 kW	38	8	1,76
900-4200	0,06 kW	50	6	1,35
900-4200	0,06 kW	55	5	1,25
900-4200	0,06 kW	75	4	0,97
900-4200	0,06 kW	100	3	0,69

Frequency inverter

Frequency inverter is available in following versions

Part no.	Voltage	Power
900-9000	230 V	0,37 kW
900-9010	400 V	0,75 kW

